

BRANCH LINE FROM HOWTH
JUNCTION TO HOWTH

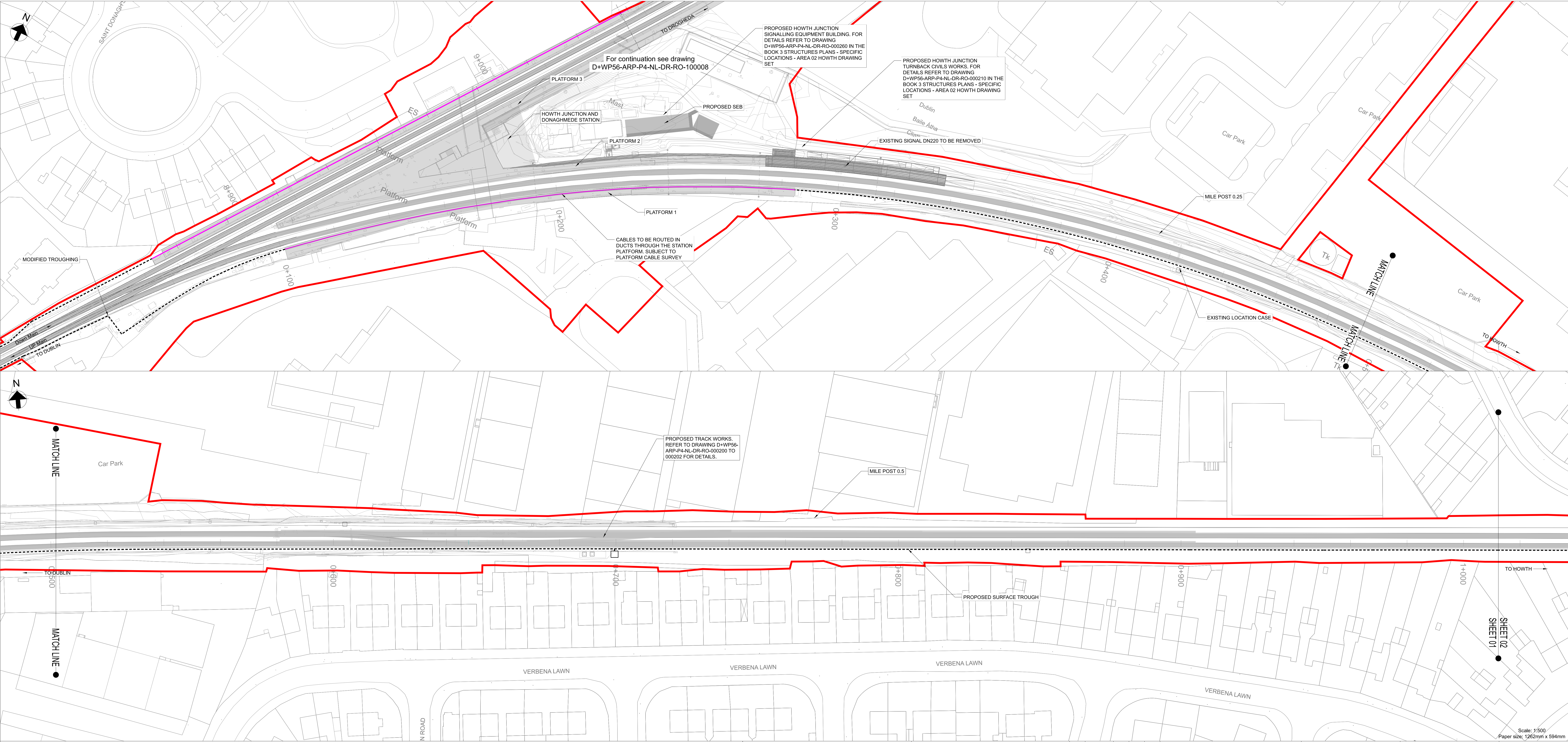

NOTES

1. DO NOT SCALE FROM THIS DRAWING.
2. THIS DRAWING SHALL BE READ IN CONJUNCTION WITH THE OTHER DRAWINGS INCLUDED IN THIS SERIES.
3. LOCATION OF ALL BURIED SERVICES TO BE CONFIRMED PRIOR TO CONSTRUCTION.
3. ALL DIMENSIONS ARE IN METERS, UNLESS OTHERWISE STATED.
4. ALL CHAINAGES ARE IN KILOMETERS.
5. DRAWING TO BE PRINTED IN COLOUR.
6. ALL LEVELS ARE IN METERS ABOVE ORDNANCE DATUM (MOD) UNLESS OTHERWISE STATED.
7. THE DART+ COASTAL NORTH PROJECT IS POSITIONED ACCORDING TO THE IRISH TRANSVERSE MERCATOR (ITM) COORDINATE SYSTEM.
8. EXISTING TROUGHING TO BE REMOVED POST CONSTRUCTION OF PROPOSED TROUGHING.
9. SELECTED INFRASTRUCTURE INTERVENTIONS DRIVING THE LINESIDE CIVILS DESIGN SUCH AS SUBSTATIONS HAVE BEEN SHOWN FOR INFORMATION ON THESE LINEAR WORKS PLANS. FOR A FULL PICTURE OF ALL INTERVENTIONS ACROSS THE PROJECT, PLEASE REFER TO THE BOOK 1 RAILWAY WORKS PLANS.
10. OHLE STRUCTURES ARE SHOWN AT INDICATIVE LOCATIONS AT A SPACING OF TYPICALLY 40m TO 50m. OHLE WIRES WILL SPAN BETWEEN THE STRUCTURES.

LEGEND

- DEVELOPMENT BOUNDARY
- EXISTING ELEMENTS
- ELEMENTS TO BE REMOVED
- PROPOSED UNDER TRACK CROSSING (UTX)
- PROPOSED TROUGHING
- PROPOSED ELEVATED TROUGHING
- PROPOSED FENCING
- CABLE DUCTS IN PLATFORM
- PROPOSED OVERHEAD LINE EQUIPMENT
- TRACKWORK (EXISTING AND PROPOSED)
- PLATFORM MODIFICATIONS
- PROPOSED SIGNAL
- PROPOSED LOCATION CASE

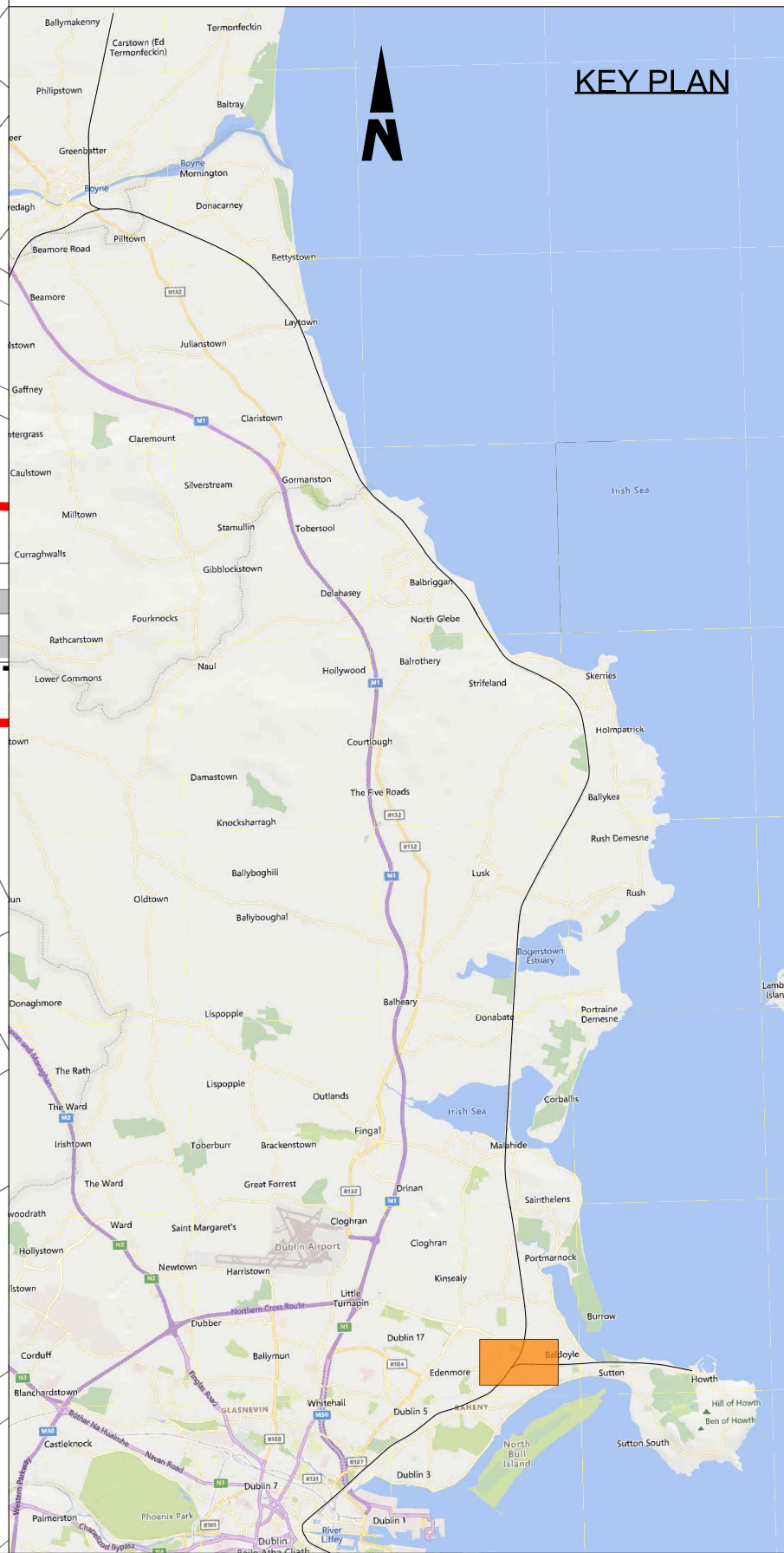

Disclaimer

© Irish Rail (2023). This drawing is confidential and the copyright in it is owned by Irish Rail. This drawing must not be either loaned, copied or otherwise reproduced in whole or in part or used for any purpose without the prior permission of Irish Rail.

© OpenStreetMap contributors

© Ordnance Survey Ireland and Government of Ireland. All O.S. data used for plans are printed under Copyright Ordnance Survey Ireland 0039723 (OSi Aerial Data or OSi Lidar Data) & 2023/OSi, NMA, 100 (OSi Vector Data). All elevations are in metres and relate to OSi Geoid Height (OSGM02). Mean Height is defined by existing Project Control. All Co-ordinates are in Irish Transverse Mercator Grid (ITM) as defined by OSi active GPS station Tallaght College (TLTG).

| Rev | Date | Dm | Chk'd | App'd | Description |
|-----|------------|----|-------|-------|----------------|
| P01 | 12/04/2024 | SF | EJ | DB | PLANNING ISSUE |
| | | | | | |
| | | | | | |
| | | | | | |
| | | | | | |

Client

Date 20/10/2023

Project Code D+WP56

Scale As shown

Originator Code ARP

Engineering Designer

Drawn SF

Checked EJ

Approved DB

OMS Code 280275-00

Project Title

DART+ COASTAL NORTH

Drawing Title

Linear Works

Howth Branch

Drawing File Name

D+WP56-ARP-P4-NL-DR-RO-100053

Sheet Number

53 of 58

Status

S3

Rev

P01

Scale: 1:500
Paper size: 1262mm x 594mm

DO NOT SCALE USE FIGURED DIMENSIONS ONLY



NOTES

1. DO NOT SCALE FROM THIS DRAWING.
2. THIS DRAWING SHALL BE READ IN CONJUNCTION WITH THE OTHER DRAWINGS INCLUDED IN THIS SERIES.
3. LOCATION OF ALL BURIED SERVICES TO BE CONFIRMED PRIOR TO CONSTRUCTION.
3. ALL DIMENSIONS ARE IN METERS, UNLESS OTHERWISE STATED.
4. ALL CHAINAGES ARE IN KILOMETERS.
5. DRAWING TO BE PRINTED IN COLOUR.
6. ALL LEVELS ARE IN METERS ABOVE ORDNANCE DATUM (MOD) UNLESS OTHERWISE STATED.
7. THE DART+ COASTAL NORTH PROJECT IS POSITIONED ACCORDING TO THE IRISH TRANSVERSE MERCATOR (ITM) COORDINATE SYSTEM.
8. EXISTING TROUGHING TO BE REMOVED POST CONSTRUCTION OF PROPOSED TROUGHING.
9. SELECTED INFRASTRUCTURE INTERVENTIONS DRIVING THE LINESIDE CIVILS DESIGN SUCH AS SUBSTATIONS HAVE BEEN SHOWN FOR INFORMATION ON THESE LINEAR WORKS PLANS. FOR A FULL PICTURE OF ALL INTERVENTIONS ACROSS THE PROJECT, PLEASE REFER TO THE BOOK 1 RAILWAY WORKS PLANS.
10. OHLE STRUCTURES ARE SHOWN AT INDICATIVE LOCATIONS AT A SPACING OF TYPICALLY 40m TO 50m. OHLE WIRES WILL SPAN BETWEEN THE STRUCTURES.

LEGEND

- DEVELOPMENT BOUNDARY
- EXISTING ELEMENTS
- ELEMENTS TO BE REMOVED
- PROPOSED UNDER TRACK CROSSING (UTC)
- - - PROPOSED TROUGHING
- - - PROPOSED ELEVATED TROUGHING
- - - PROPOSED FENCING
- CABLE DUCTS IN PLATFORM
- PROPOSED OVERHEAD LINE EQUIPMENT
- TRACKWORK (EXISTING AND PROPOSED)
- PLATFORM MODIFICATIONS
- PROPOSED SIGNAL
- PROPOSED LOCATION CASE

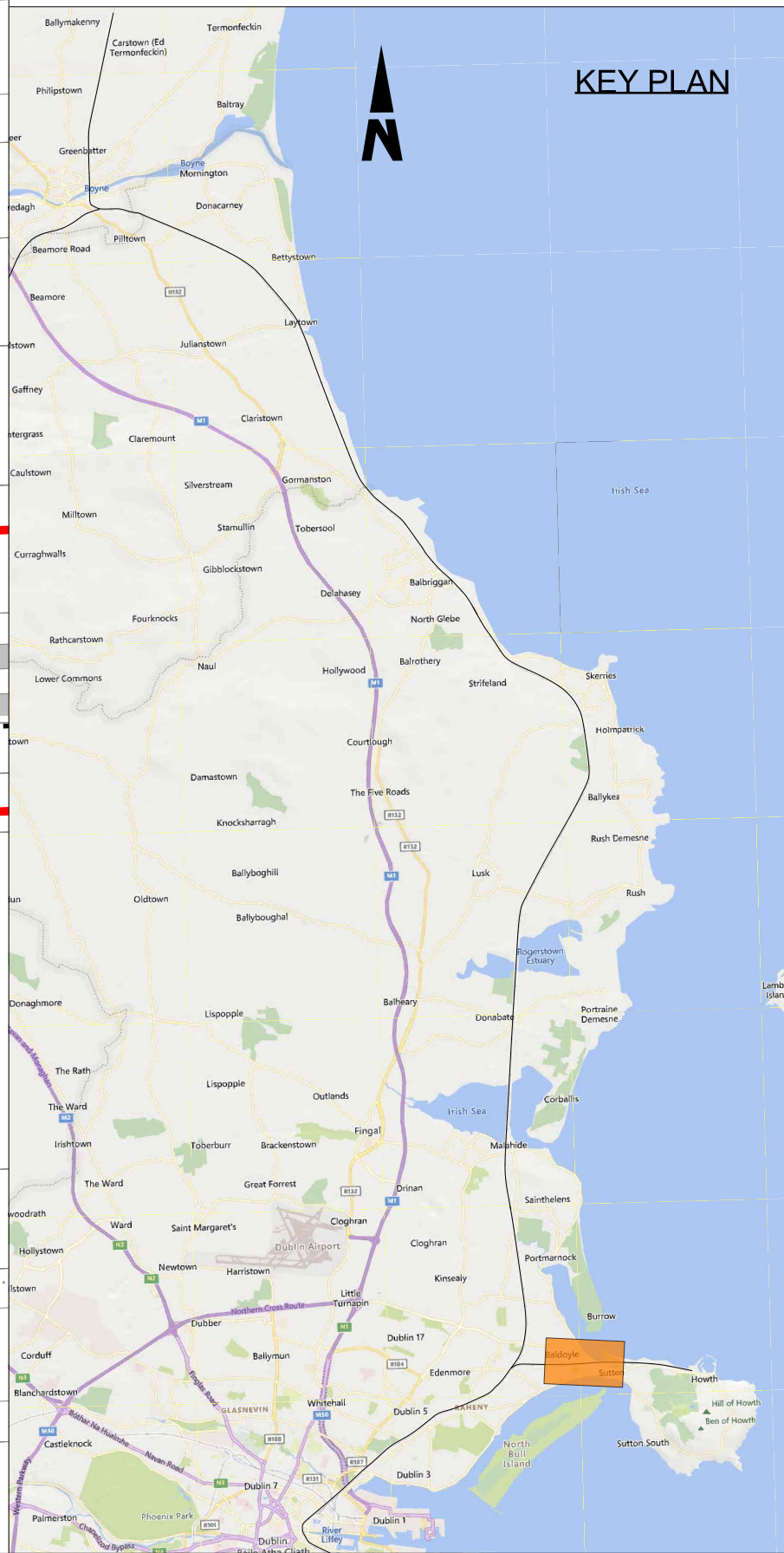

Disclaimer

© Irish Rail (2023). This drawing is confidential and the copyright in it is owned by Irish Rail. This drawing must not be either loaned, copied or otherwise reproduced in whole or in part or used for any purpose without the prior permission of Irish Rail.

© OpenStreetMap contributors

© Ordnance Survey Ireland and Government of Ireland. All O.S. data used for plans are printed under Copyright Ordnance Survey Ireland 0039723 (OSi Aerial Data or OSi Lidar Data) & 2023 OSi, NMA, 100 (OSi Vector Data). All elevations are in metres and relate to OSi Geoid Model (OSGM02). Mean Height is defined by existing Project Control. All Co-ordinates are in Irish Transverse Mercator Grid (ITM) as defined by OSi active GPS station Tallaght College (TLTG).

| Rev | Date | Dm | Chk'd | App'd | Description |
|-----|------------|----|-------|-------|----------------|
| P01 | 12/04/2024 | SF | EJ | DB | PLANNING ISSUE |
| | | | | | |
| | | | | | |
| | | | | | |
| | | | | | |

Client

Engineering Designer

| Date | Scale | Drawn | Checked | Approved |
|------------|----------|-------|---------|----------|
| 20/10/2023 | As shown | SF | EJ | DB |

Project Code

D+WP56

Originator Code

ARP

OMS Code

280275-00

Project Title

DART+ COASTAL NORTH

Drawing Title

Linear Works
Howth Branch

Drawing File Name

D+WP56-ARP-P4-NL-DR-RO-100054

Sheet Number

54 of 58

Status

S3

Rev

P01

Scale : 1:500
Paper size: 1261mm x 594mm

DO NOT SCALE USE FIGURED DIMENSIONS ONLY

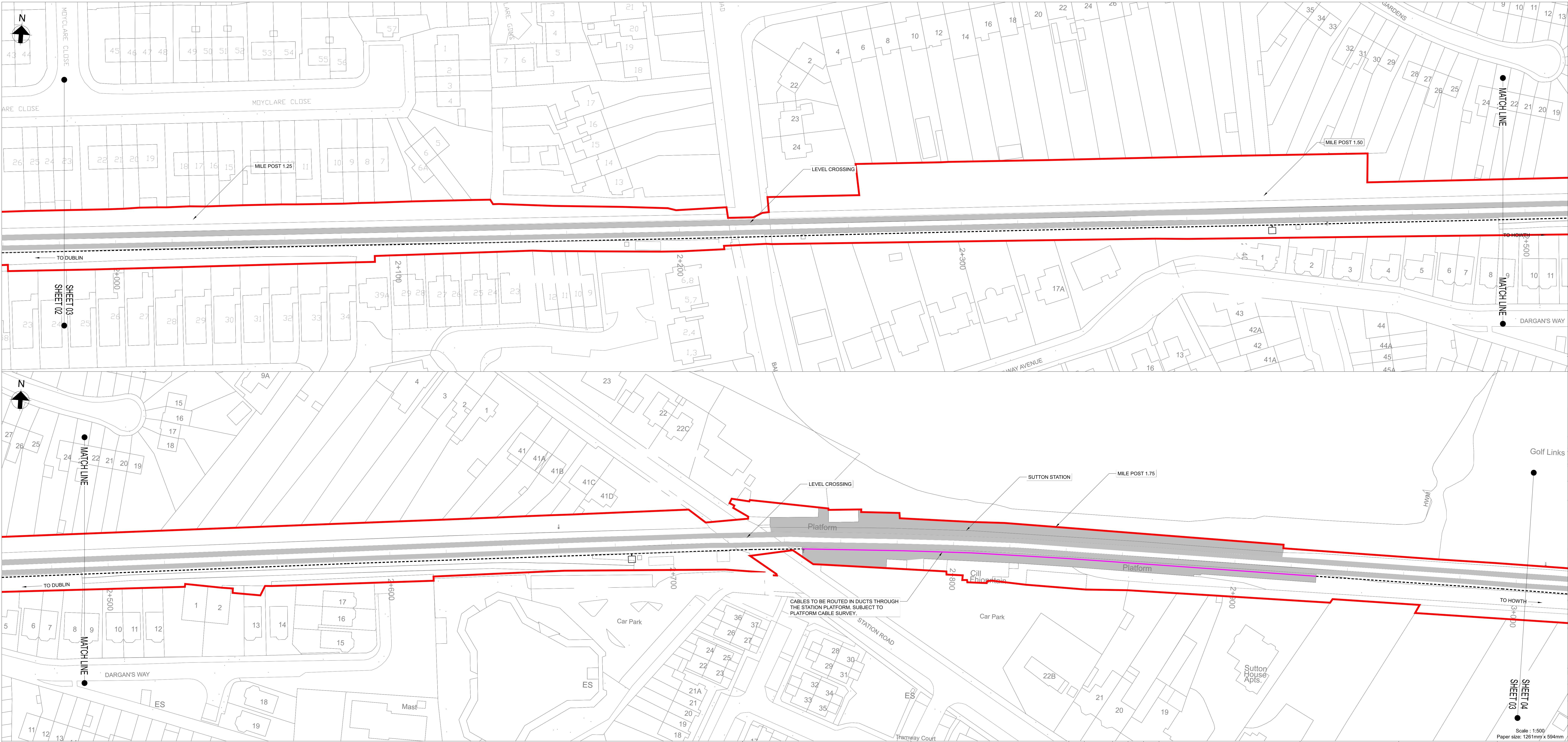

NOTES

1. DO NOT SCALE FROM THIS DRAWING.
2. THIS DRAWING SHALL BE READ IN CONJUNCTION WITH THE OTHER DRAWINGS INCLUDED IN THIS SERIES.
3. LOCATION OF ALL BURIED SERVICES TO BE CONFIRMED PRIOR TO CONSTRUCTION.
4. ALL DIMENSIONS ARE IN METERS, UNLESS OTHERWISE STATED.
4. ALL CHAINAGES ARE IN KILOMETERS.
5. DRAWING TO BE PRINTED IN COLOUR.
6. ALL LEVELS ARE IN METERS ABOVE ORDNANCE DATUM (MOD) UNLESS OTHERWISE STATED.
7. THE DART+ COASTAL NORTH PROJECT IS POSITIONED ACCORDING TO THE IRISH TRANSVERSE MERCATOR (ITM) COORDINATE SYSTEM.
8. EXISTING TROUGHING TO BE REMOVED POST CONSTRUCTION OF PROPOSED TROUGHING.
9. SELECTED INFRASTRUCTURE INTERVENTIONS DRIVING THE LINESIDE CIVILS DESIGN SUCH AS SUBSTATIONS HAVE BEEN SHOWN FOR INFORMATION ON THESE LINEAR WORKS PLANS. FOR A FULL PICTURE OF ALL INTERVENTIONS ACROSS THE PROJECT, PLEASE REFER TO THE BOOK 1 RAILWAY WORKS PLANS.
10. OHLE STRUCTURES ARE SHOWN AT INDICATIVE LOCATIONS AT A SPACING OF TYPICALLY 40m TO 50m. OHLE WIRES WILL SPAN BETWEEN THE STRUCTURES.

LEGEND

- DEVELOPMENT BOUNDARY
- EXISTING ELEMENTS
- ELEMENTS TO BE REMOVED
- PROPOSED UNDER TRACK CROSSING (UTX)
- PROPOSED TROUGHING
- PROPOSED ELEVATED TROUGHING
- PROPOSED FENCING
- CABLE DUCTS IN PLATFORM
- PROPOSED OVERHEAD LINE EQUIPMENT
- TRACKWORK (EXISTING AND PROPOSED)
- PLATFORM MODIFICATIONS
- PROPOSED SIGNAL
- PROPOSED LOCATION CASE

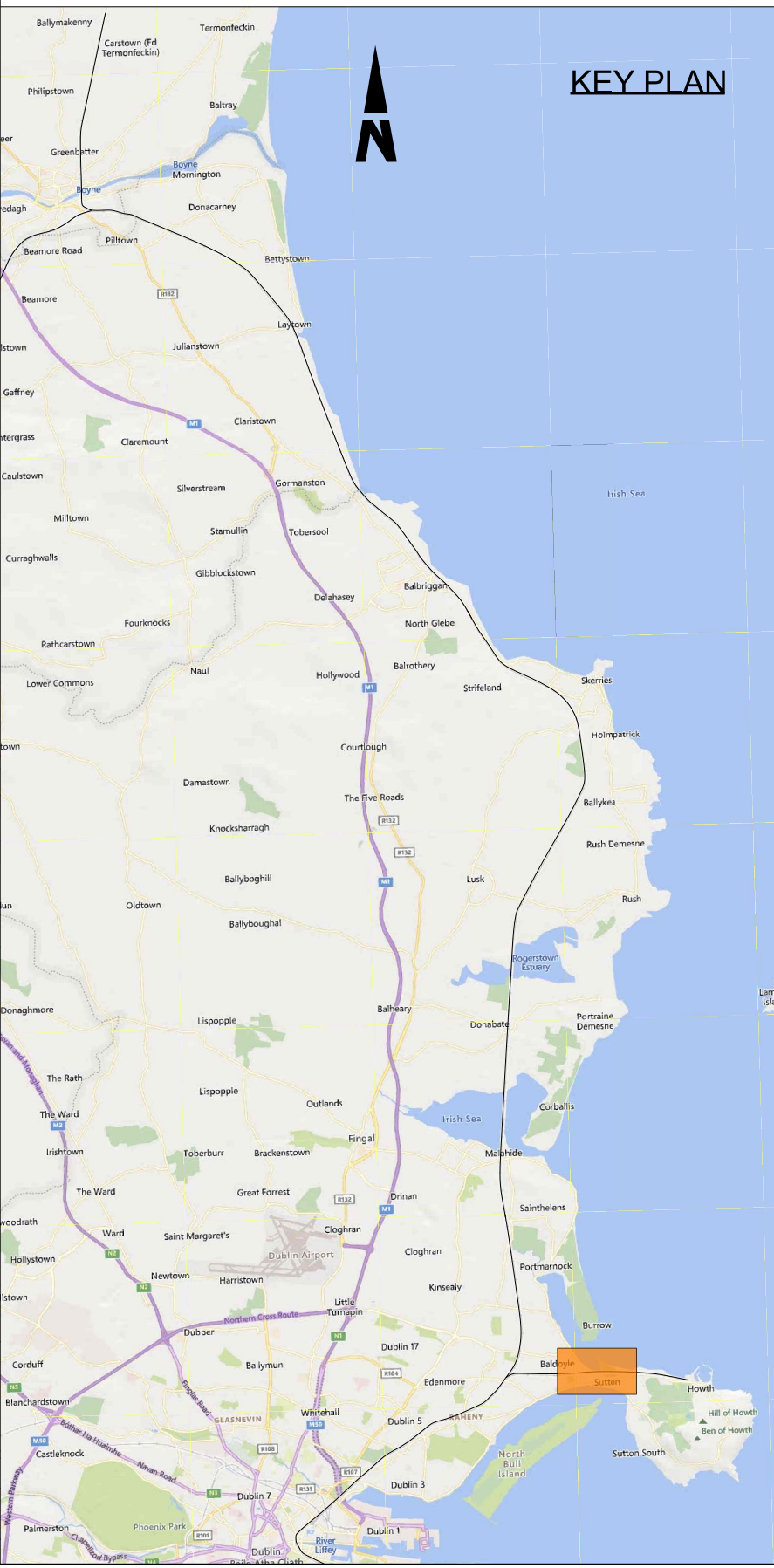

| <div>Disclaimer</div> <div>© Irish Rail (2023). This drawing is confidential and the copyright in it is owned by Irish Rail. This drawing must not be either loaned, copied or otherwise reproduced in whole or in part or used for any purpose without the prior permission of Irish Rail.</div> <div>© OpenStreetMap contributors</div> <div>Ordnance Survey Ireland and Government of Ireland. All O.S. data used for plans are printed under Copyright Ordnance Survey Ireland 0039723 (OSi Aerial Data or OSi Lidar Data) & 2023/OSi, NMA, 100 (OSi Vector Data). All elevations are in metres and relate to OSi Geoid Model (OSGM02). Main Head is defined by existing Project Control. All Co-ordinates are in Irish Transverse Mercator Grid (ITM) as defined by OSi active GPS station Tallaght College (TLTG).</div> | | | | | | | | | | <div><div><div><div></div><div></div><div></div></div><div><div>DART+</div><div>Coastal North</div></div></div><div><div><div>NTA</div><div>National Transport Authority</div></div><div><div><div></div><div></div><div></div></div><div><div>Tionscail Éireann</div><div>Project Ireland</div><div>2040</div></div></div></div></div> | | | <table><tr><th>Rev</th><th>Date</th><th>Dm</th><th>Chk'd</th><th>App'd</th><th>Description</th></tr><tr><td>P01</td><td>12/04/2024</td><td>SF</td><td>EJ</td><td>DB</td><td>PLANNING ISSUE</td></tr><tr><td> </td><td> </td><td> </td><td> </td><td> </td><td> </td></tr><tr><td> </td><td> </td><td> </td><td> </td><td> </td><td> </td></tr><tr><td> </td><td> </td><td> </td><td> </td><td> </td><td> </td></tr></table> | Rev | Date | Dm | Chk'd | App'd | Description | P01 | 12/04/2024 | SF | EJ | DB | PLANNING ISSUE | | | | | | | | | | | | | | | | | | | <div><div><div><div></div><div></div><div></div></div><div><div>larnród Éireann</div><div>Irish Rail</div></div></div><div><div><div></div><div></div><div></div></div><div><div>ARUP</div></div></div></div> | <table><tr><th>Date</th><th>Scale</th><th>As shown</th><th>Drawn</th><th>Checked</th><th>EJ</th><th>Approved</th><th>DB</th></tr><tr><td>20/10/2023</td><td>SF</td><td> </td><td> </td><td> </td><td> </td><td> </td><td> </td></tr></table> | Date | Scale | As shown | Drawn | Checked | EJ | Approved | DB | 20/10/2023 | SF | | | | | | | <table><tr><th>Project Code</th><th>Originator Code</th><th>OMS Code</th></tr><tr><td>D+WP56</td><td>ARP</td><td>280275-00</td></tr></table> | Project Code | Originator Code | OMS Code | D+WP56 | ARP | 280275-00 | <table><tr><th>Drawing File Name</th><th>Sheet Number</th><th>Status</th><th>Rev</th></tr><tr><td>D+WP56-ARP-P4-NL-DR-RO-100055</td><td>55 of 58</td><td>S3</td><td>P01</td></tr></table> | Drawing File Name | Sheet Number | Status | Rev | D+WP56-ARP-P4-NL-DR-RO-100055 | 55 of 58 | S3 | P01 |
|--|-----------------|-----------|-------|---------|----------------|----------|----|--|--|---|--|--|---|-----|------|----|-------|-------|-------------|-----|------------|----|----|----|----------------|--|--|--|--|--|--|--|--|--|--|--|--|--|--|--|--|--|--|---|--|------|-------|----------|-------|---------|----|----------|----|------------|----|--|--|--|--|--|--|--|--------------|-----------------|----------|--------|-----|-----------|---|-------------------|--------------|--------|-----|-------------------------------|----------|----|-----|
| Rev | Date | Dm | Chk'd | App'd | Description | | | | | | | | | | | | | | | | | | | | | | | | | | | | | | | | | | | | | | | | | | | | | | | | | | | | | | | | | | | | | | | | | | | | | | | | |
| P01 | 12/04/2024 | SF | EJ | DB | PLANNING ISSUE | | | | | | | | | | | | | | | | | | | | | | | | | | | | | | | | | | | | | | | | | | | | | | | | | | | | | | | | | | | | | | | | | | | | | | | | |
| | | | | | | | | | | | | | | | | | | | | | | | | | | | | | | | | | | | | | | | | | | | | | | | | | | | | | | | | | | | | | | | | | | | | | | | | | | | | | |
| | | | | | | | | | | | | | | | | | | | | | | | | | | | | | | | | | | | | | | | | | | | | | | | | | | | | | | | | | | | | | | | | | | | | | | | | | | | | | |
| | | | | | | | | | | | | | | | | | | | | | | | | | | | | | | | | | | | | | | | | | | | | | | | | | | | | | | | | | | | | | | | | | | | | | | | | | | | | | |
| Date | Scale | As shown | Drawn | Checked | EJ | Approved | DB | | | | | | | | | | | | | | | | | | | | | | | | | | | | | | | | | | | | | | | | | | | | | | | | | | | | | | | | | | | | | | | | | | | | | | |
| 20/10/2023 | SF | | | | | | | | | | | | | | | | | | | | | | | | | | | | | | | | | | | | | | | | | | | | | | | | | | | | | | | | | | | | | | | | | | | | | | | | | | | | |
| Project Code | Originator Code | OMS Code | | | | | | | | | | | | | | | | | | | | | | | | | | | | | | | | | | | | | | | | | | | | | | | | | | | | | | | | | | | | | | | | | | | | | | | | | | | |
| D+WP56 | ARP | 280275-00 | | | | | | | | | | | | | | | | | | | | | | | | | | | | | | | | | | | | | | | | | | | | | | | | | | | | | | | | | | | | | | | | | | | | | | | | | | | |
| Drawing File Name | Sheet Number | Status | Rev | | | | | | | | | | | | | | | | | | | | | | | | | | | | | | | | | | | | | | | | | | | | | | | | | | | | | | | | | | | | | | | | | | | | | | | | | | |
| D+WP56-ARP-P4-NL-DR-RO-100055 | 55 of 58 | S3 | P01 | | | | | | | | | | | | | | | | | | | | | | | | | | | | | | | | | | | | | | | | | | | | | | | | | | | | | | | | | | | | | | | | | | | | | | | | | | |

DO NOT SCALE USE FIGURED DIMENSIONS ONLY

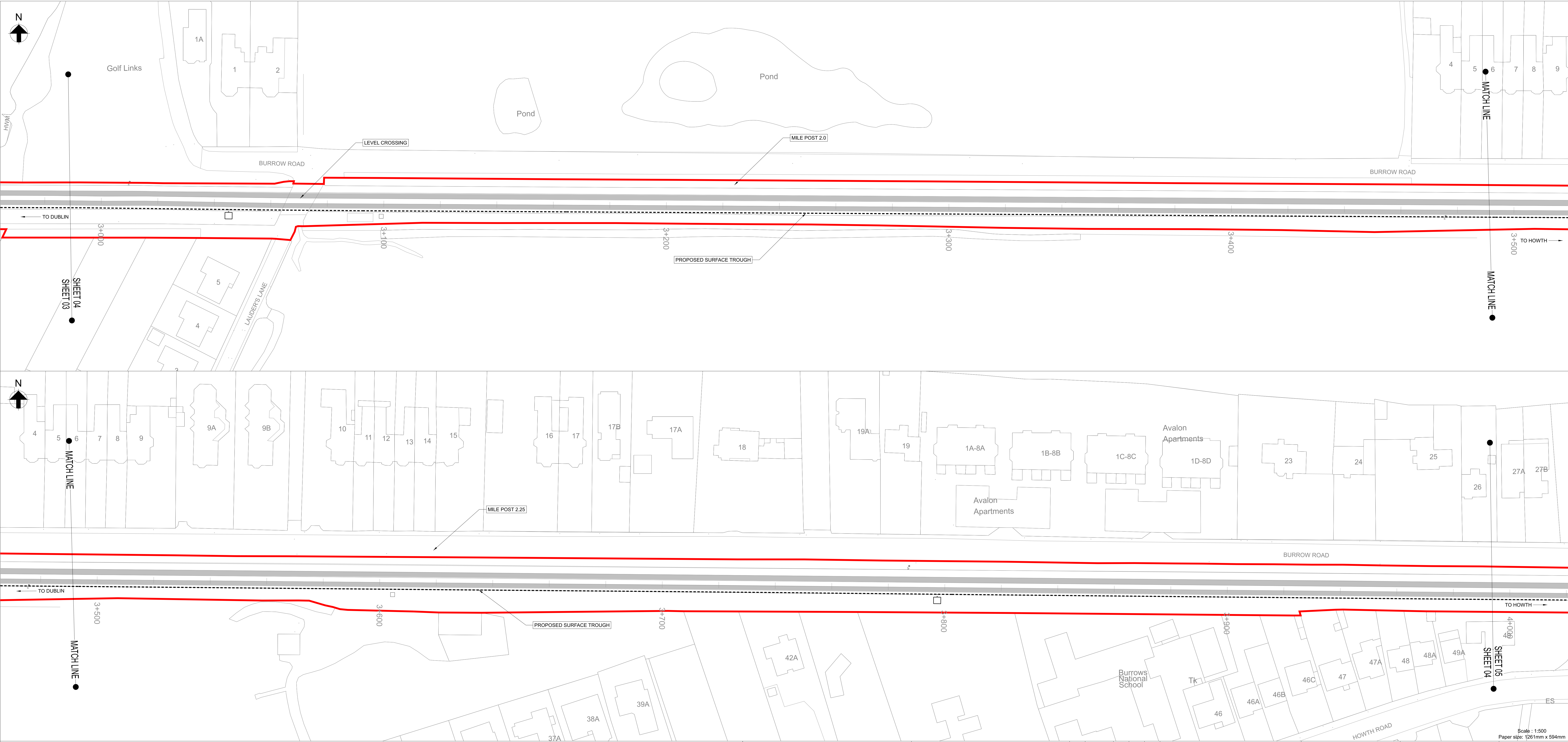

NOTES

1. DO NOT SCALE FROM THIS DRAWING.
2. THIS DRAWING SHALL BE READ IN CONJUNCTION WITH THE OTHER DRAWINGS INCLUDED IN THIS SERIES.
3. LOCATION OF ALL BURIED SERVICES TO BE CONFIRMED PRIOR TO CONSTRUCTION.
3. ALL DIMENSIONS ARE IN METERS, UNLESS OTHERWISE STATED.
4. ALL CHAINAGES ARE IN KILOMETERS.
5. DRAWING TO BE PRINTED IN COLOUR.
6. ALL LEVELS ARE IN METERS ABOVE ORDNANCE DATUM (MOD) UNLESS OTHERWISE STATED.
7. THE DART+ COASTAL NORTH PROJECT IS POSITIONED ACCORDING TO THE IRISH TRANSVERSE MERCATOR (ITM) COORDINATE SYSTEM.
8. EXISTING TROUGHING TO BE REMOVED POST CONSTRUCTION OF PROPOSED TROUGHING.
9. SELECTED INFRASTRUCTURE INTERVENTIONS DRIVING THE LINESIDE CIVILS DESIGN SUCH AS SUBSTATIONS HAVE BEEN SHOWN FOR INFORMATION ON THESE LINEAR WORKS PLANS. FOR A FULL PICTURE OF ALL INTERVENTIONS ACROSS THE PROJECT, PLEASE REFER TO THE BOOK 1 RAILWAY WORKS PLANS.
10. OHLE STRUCTURES ARE SHOWN AT INDICATIVE LOCATIONS AT A SPACING OF TYPICALLY 40m TO 50m. OHLE WIRES WILL SPAN BETWEEN THE STRUCTURES.

LEGEND

- DEVELOPMENT BOUNDARY
- EXISTING ELEMENTS
- ELEMENTS TO BE REMOVED
- PROPOSED UNDER TRACK CROSSING (UTX)
- PROPOSED TROUGHING
- PROPOSED ELEVATED TROUGHING
- PROPOSED FENCING
- CABLE DUCTS IN PLATFORM
- PROPOSED OVERHEAD LINE EQUIPMENT
- TRACKWORK (EXISTING AND PROPOSED)
- PLATFORM MODIFICATIONS
- PROPOSED SIGNAL
- PROPOSED LOCATION CASE

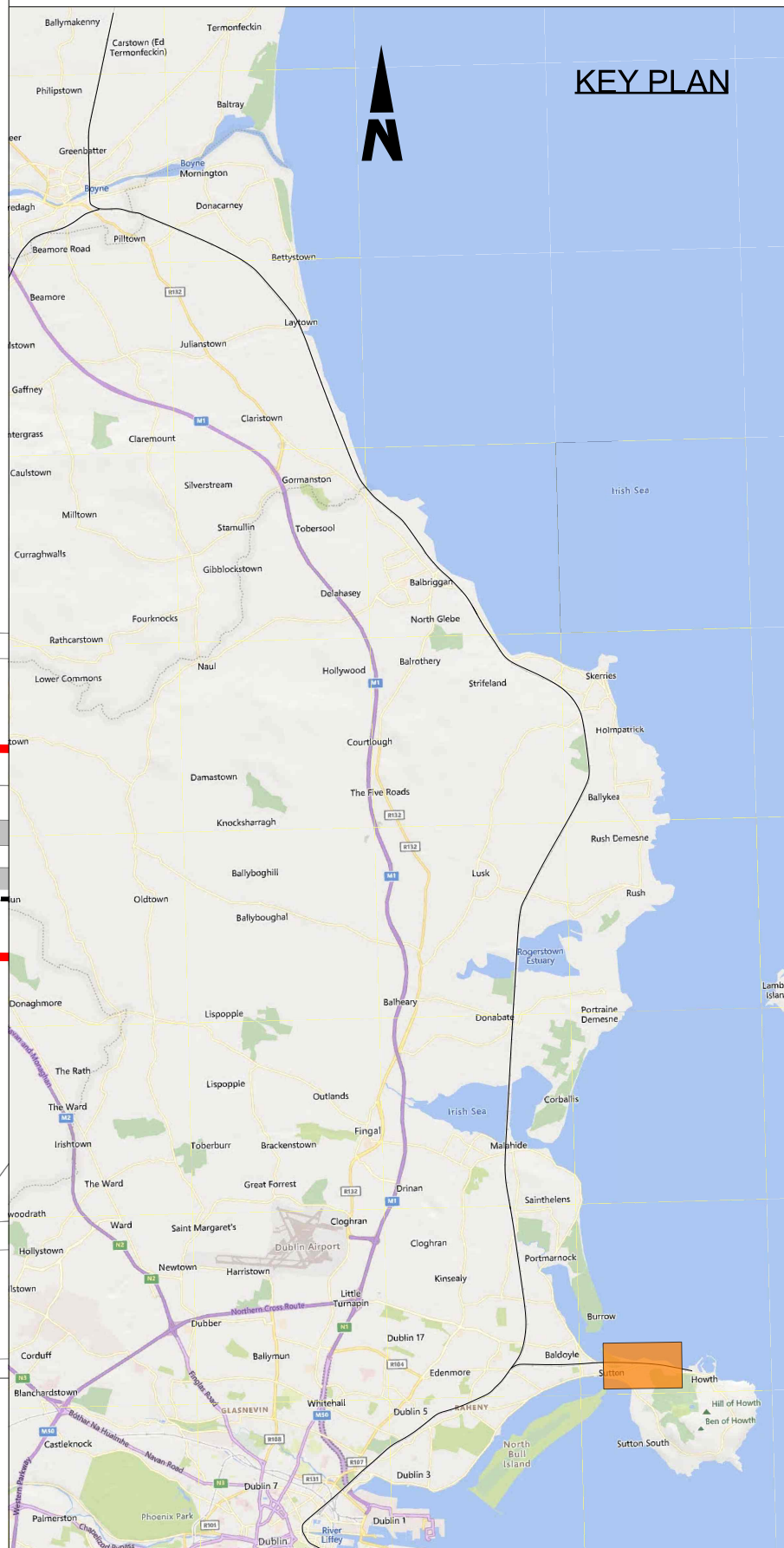

Disclaimer

© Irish Rail (2023). This drawing is confidential and the copyright in it is owned by Irish Rail. This drawing must not be either loaned, copied or otherwise reproduced in whole or in part or used for any purpose without the prior permission of Irish Rail.

© OpenStreetMap contributors

© Ordnance Survey Ireland and Government of Ireland. All O.S. data used for plans are printed under Copyright Ordnance Survey Ireland 0039723 (OSi Aerial Data or OSi Lidar Data) & 2023/OSi, NMA, 180 (OSi Vector Data). All elevations are in metres and relate to OSi Geoid Model (OSGM02). Main Head is defined by existing Project Control. All Co-ordinates are in Irish Transverse Mercator Grid (ITM) as defined by OSi active GPS station Tallaght College (TLTG).

| Rev | Date | Dm | Chk'd | App'd | Description |
|-----|------------|----|-------|-------|----------------|
| P01 | 12/04/2024 | SF | EJ | DB | PLANNING ISSUE |
| | | | | | |
| | | | | | |
| | | | | | |
| | | | | | |

larnród Éireann
Irish Rail

20/10/2023

Scale As shown

Project Code D+WP56

Originator Code ARP

OMS Code 280275-00

Engineering Designer

Drawn SF

Checked EJ

Approved DB

Client

Project Title

Drawing Title

Drawing File Name D+WP56-ARP-P4-NL-DR-RO-100056

Project Title

DART+ COASTAL NORTH

Linear Works

Howth Branch

Sheet Number 56 of 58

Status S3

Rev P01

Scale : 1:500

Paper size: 1261mm x 594mm

DO NOT SCALE USE FIGURED DIMENSIONS ONLY

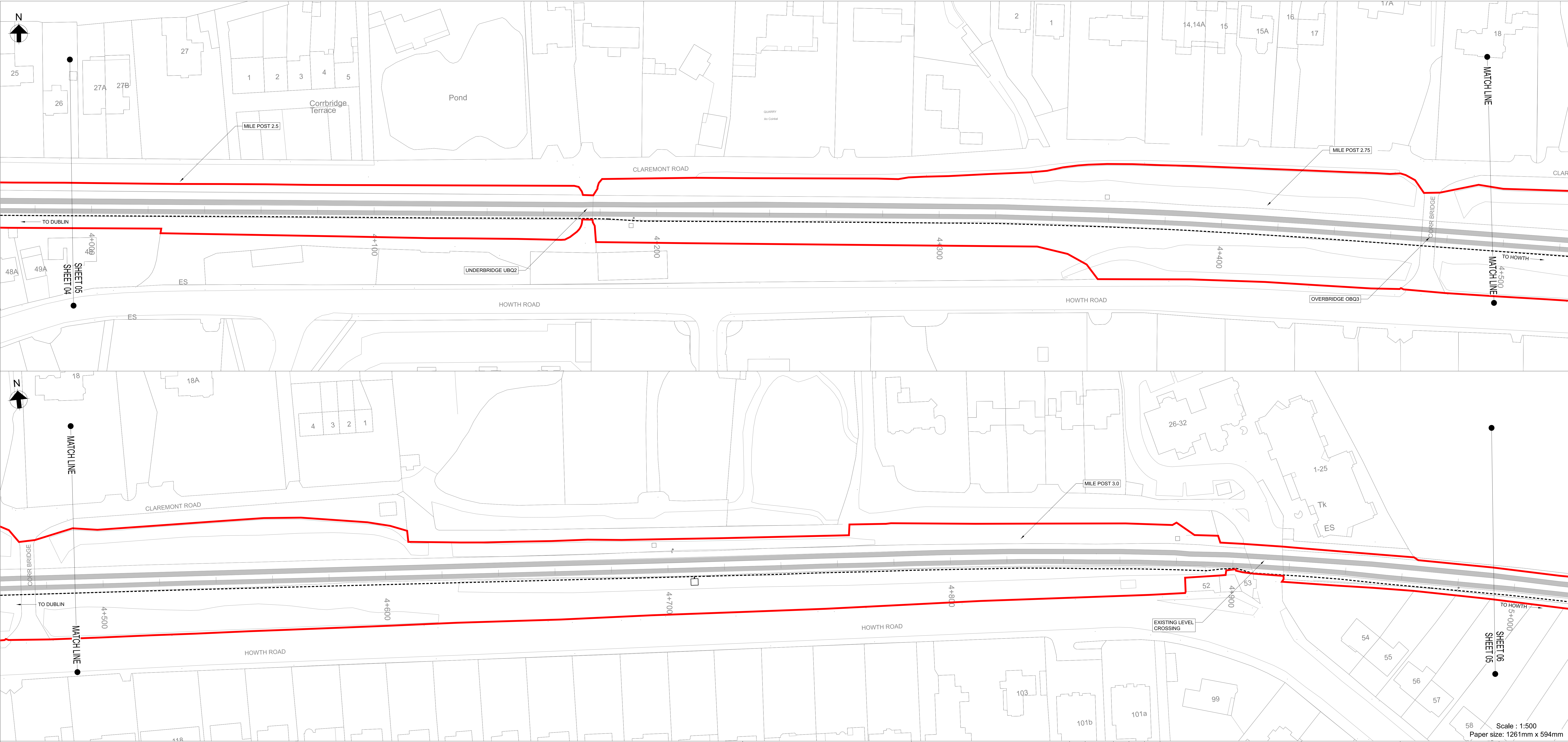

NOTES

1. DO NOT SCALE FROM THIS DRAWING.
2. THIS DRAWING SHALL BE READ IN CONJUNCTION WITH THE OTHER DRAWINGS INCLUDED IN THIS SERIES.
3. LOCATION OF ALL BURIED SERVICES TO BE CONFIRMED PRIOR TO CONSTRUCTION.
3. ALL DIMENSIONS ARE IN METERS, UNLESS OTHERWISE STATED.
4. ALL CHAINAGES ARE IN KILOMETERS.
5. DRAWING TO BE PRINTED IN COLOUR.
6. ALL LEVELS ARE IN METERS ABOVE ORDNANCE DATUM (MOD) UNLESS OTHERWISE STATED.
7. THE DART+ COASTAL NORTH PROJECT IS POSITIONED ACCORDING TO THE IRISH TRANSVERSE MERCATOR (ITM) COORDINATE SYSTEM.
8. EXISTING TROUGHING TO BE REMOVED POST CONSTRUCTION OF PROPOSED TROUGHING.
9. SELECTED INFRASTRUCTURE INTERVENTIONS DRIVING THE LINESIDE CIVILS DESIGN SUCH AS SUBSTATIONS HAVE BEEN SHOWN FOR INFORMATION ON THESE LINEAR WORKS PLANS. FOR A FULL PICTURE OF ALL INTERVENTIONS ACROSS THE PROJECT, PLEASE REFER TO THE BOOK 1 RAILWAY WORKS PLANS.
10. OHLE STRUCTURES ARE SHOWN AT INDICATIVE LOCATIONS AT A SPACING OF TYPICALLY 40m TO 50m. OHLE WIRES WILL SPAN BETWEEN THE STRUCTURES.

LEGEND

- DEVELOPMENT BOUNDARY
- EXISTING ELEMENTS
- ELEMENTS TO BE REMOVED
- PROPOSED UNDER TRACK CROSSING (UTX)
- PROPOSED TROUGHING
- PROPOSED ELEVATED TROUGHING
- PROPOSED FENCING
- CABLE DUCTS IN PLATFORM
- PROPOSED OVERHEAD LINE EQUIPMENT
- TRACKWORK (EXISTING AND PROPOSED)
- PLATFORM MODIFICATIONS
- PROPOSED SIGNAL
- PROPOSED LOCATION CASE

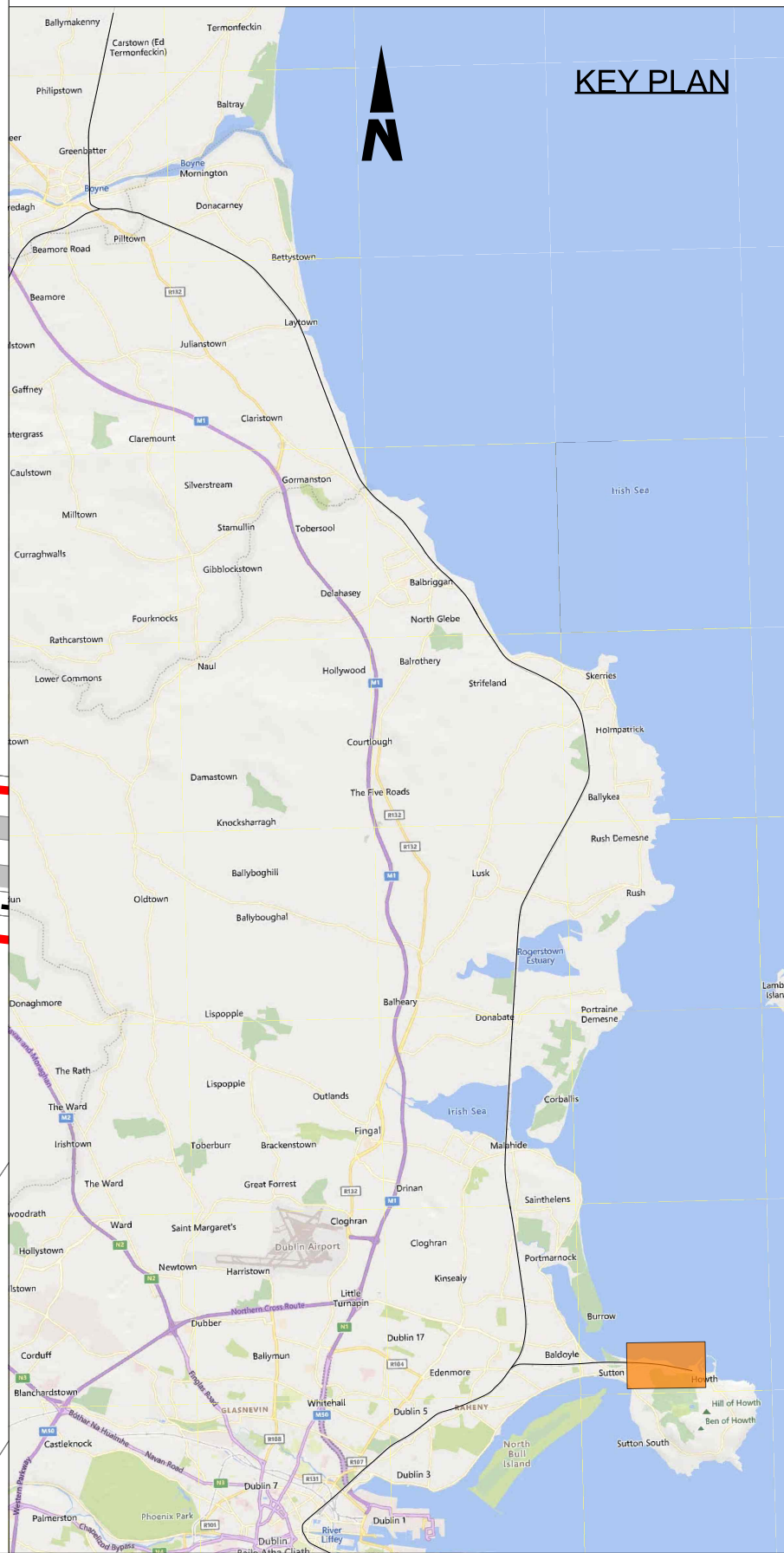

Scale : 1:500
Paper size: 1261mm x 594mm

Disclaimer
© Irish Rail (2023). This drawing is confidential and the copyright in it is owned by Irish Rail. This drawing must not be either loaned, copied or otherwise reproduced in whole or in part or used for any purpose without the prior permission of Irish Rail.
© OpenStreetMap contributors
© Ordnance Survey Ireland and Government of Ireland. All O.S. data used for plans are printed under Copyright Ordnance Survey Ireland 0039723 (OSi Aerial Data or OSi Lidar Data) & 2023 OSi NMA_100 (OSi Vector Data). All elevations are in metres and relate to OSi Geoid Height (OSGM02). Main Head is defined by existing Project Control. All Co-ordinates are in Irish Transverse Mercator Grid (ITM) as defined by OSi active GPS station Tallaght College (TLTG).



| Rev | Date | Dm | Ch'd | App'd | Description |
|-----|------------|----|------|-------|----------------|
| P01 | 12/04/2024 | SF | EJ | DB | PLANNING ISSUE |
| | | | | | |
| | | | | | |
| | | | | | |
| | | | | | |

| | | | | |
|---|------------------------|-------------------------------------|---------------|----------------|
| Client Iarnród Éireann Irish Rail | | Engineering Designer ARUP | | |
| Date 20/10/2023 | Scale As shown | Drawn SF | Checked EJ | Approved DB |
| Project Code D+WP56 | Originator Code ARP | OMS Code 280275-00 | | |

| | | | | |
|--|--------------------------|--------------|------------|--|
| Project Title DART+ COASTAL NORTH | | | | |
| Drawing Title Linear Works Howth Branch | | | | |
| Drawing File Name D+WP56-ARP-P4-NL-DR-RO-100057 | Sheet Number 57 of 58 | Status S3 | Rev P01 | |

DO NOT SCALE USE FIGURED DIMENSIONS ONLY

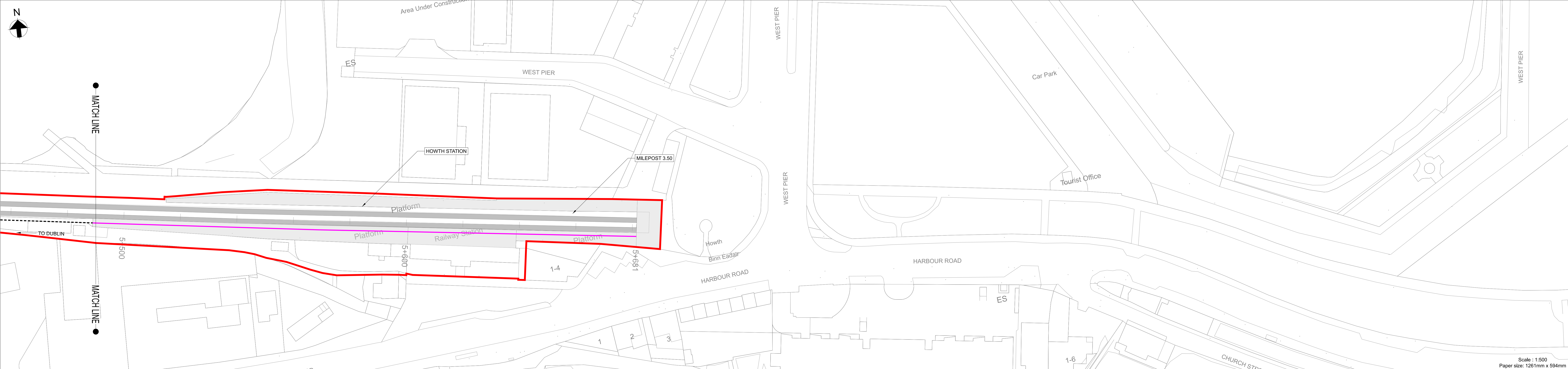
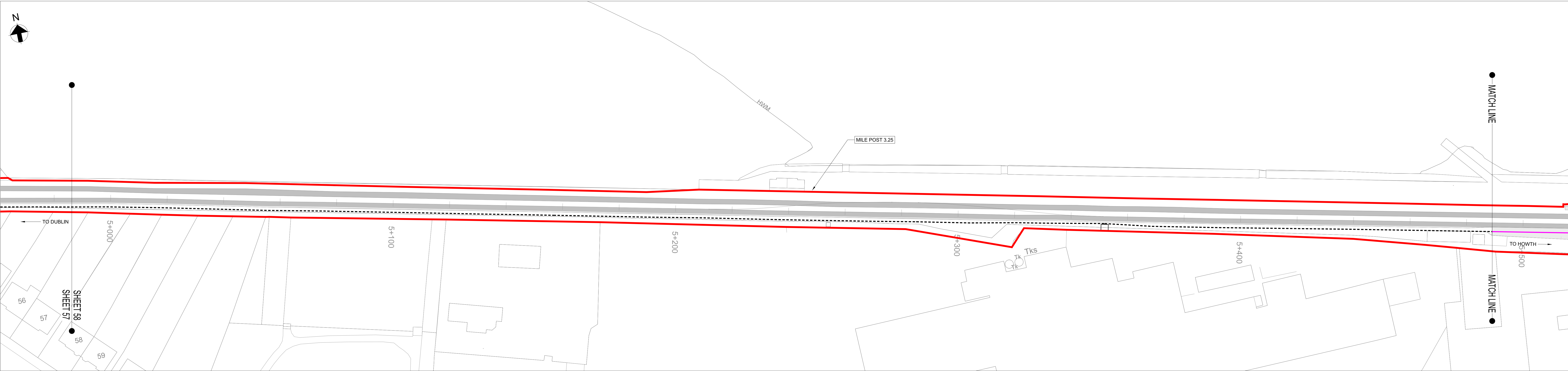

NOTES

1. DO NOT SCALE FROM THIS DRAWING.
2. THIS DRAWING SHALL BE READ IN CONJUNCTION WITH THE OTHER DRAWINGS INCLUDED IN THIS SERIES.
3. LOCATION OF ALL BURIED SERVICES TO BE CONFIRMED PRIOR TO CONSTRUCTION.
3. ALL DIMENSIONS ARE IN METERS, UNLESS OTHERWISE STATED.
4. ALL CHAINAGES ARE IN KILOMETERS.
5. DRAWING TO BE PRINTED IN COLOUR.
6. ALL LEVELS ARE IN METERS ABOVE ORDNANCE DATUM (MOD) UNLESS OTHERWISE STATED.
7. THE DART+ COASTAL NORTH PROJECT IS POSITIONED ACCORDING TO THE IRISH TRANSVERSE MERCATOR (ITM) COORDINATE SYSTEM.
8. EXISTING TROUGHING TO BE REMOVED POST CONSTRUCTION OF PROPOSED TROUGHING.
9. SELECTED INFRASTRUCTURE INTERVENTIONS DRIVING THE LINESIDE CIVILS DESIGN SUCH AS SUBSTATIONS HAVE BEEN SHOWN FOR INFORMATION ON THESE LINEAR WORKS PLANS. FOR A FULL PICTURE OF ALL INTERVENTIONS ACROSS THE PROJECT, PLEASE REFER TO THE BOOK 1 RAILWAY WORKS PLANS.
10. OHLE STRUCTURES ARE SHOWN AT INDICATIVE LOCATIONS AT A SPACING OF TYPICALLY 40m TO 50m. OHLE WIRES WILL SPAN BETWEEN THE STRUCTURES.

LEGEND

- DEVELOPMENT BOUNDARY
- EXISTING ELEMENTS
- ELEMENTS TO BE REMOVED
- PROPOSED UNDER TRACK CROSSING (UTX)
- - - PROPOSED TROUGHING
- - - PROPOSED ELEVATED TROUGHING
- - - PROPOSED FENCING
- CABLE DUCTS IN PLATFORM
- PROPOSED OVERHEAD LINE EQUIPMENT
- TRACKWORK (EXISTING AND PROPOSED)
- ▨ PLATFORM MODIFICATIONS
- ⊕ PROPOSED SIGNAL
- PROPOSED LOCATION CASE

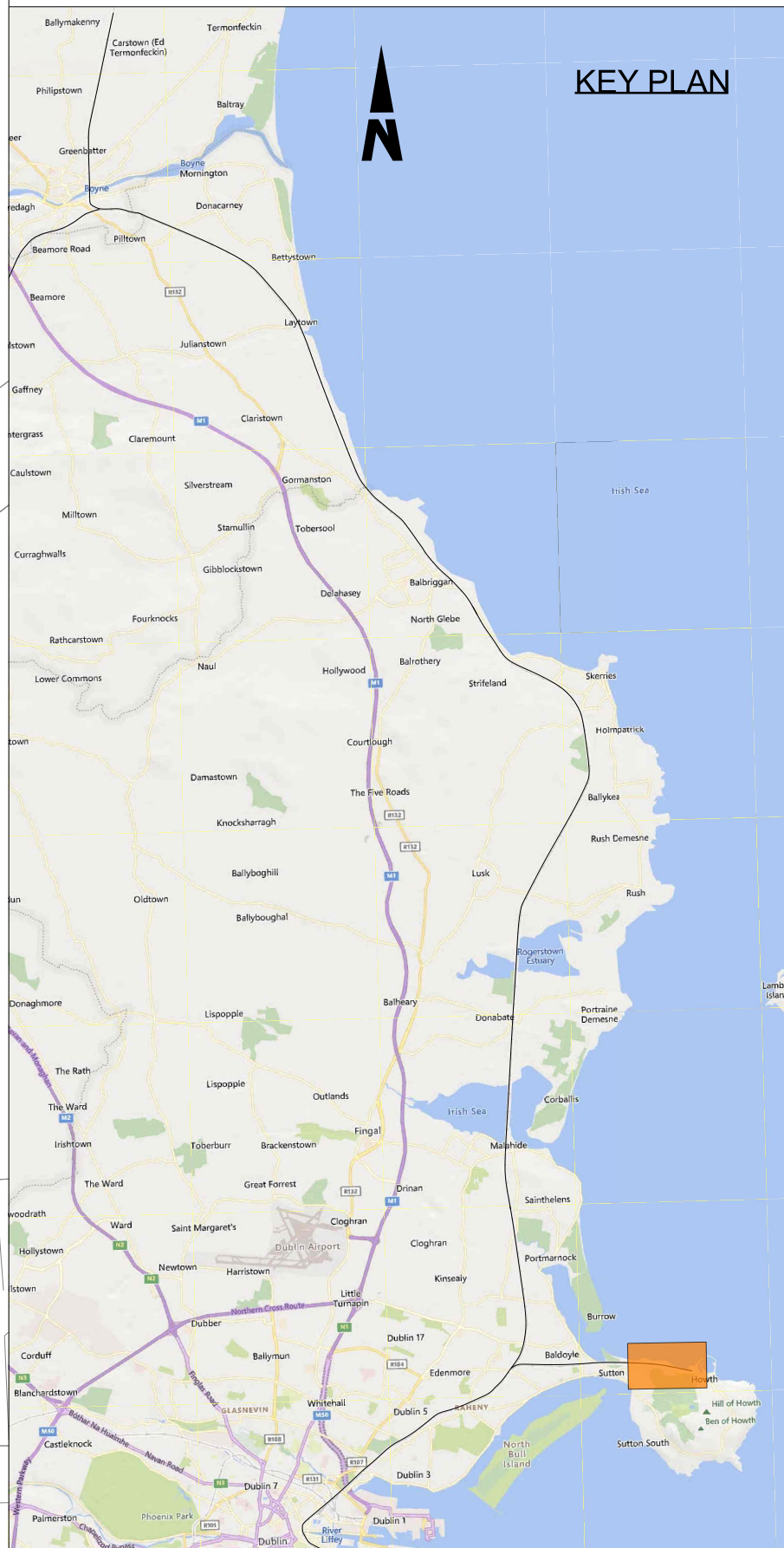

Disclaimer
© Irish Rail (2023). This drawing is confidential and the copyright in it is owned by Irish Rail. This drawing must not be either loaned, copied or otherwise reproduced in whole or in part or used for any purpose without the prior permission of Irish Rail.
© OpenStreetMap contributors
© Ordnance Survey Ireland and Government of Ireland. All O.S. data used for plans are printed under Copyright Ordnance Survey Ireland 0039723 (OSi Aerial Data or OSi Lidar Data) & 2023/OSi NMA 100 (OSi Vector Data). All elevations are in metres and relate to OSi Geoid Model (OSGM02). Main Heat is defined by existing Project Control. All Co-ordinates are in Irish Transverse Mercator Grid (ITM) as defined by OSi active GPS station Tallaght College (TLTG).



| Rev | Date | Dm | Chk'd | App'd | Description |
|-----|------------|----|-------|-------|----------------|
| P01 | 12/04/2024 | SF | EJ | DB | PLANNING ISSUE |
| | | | | | |
| | | | | | |
| | | | | | |
| | | | | | |

Client
Iarnród Éireann
Irish Rail

Date 20/10/2023 Scale As shown

Project Code D+WP56 Originator Code ARP

Engineering Designer
ARUP

Drawn SF Checked EJ Approved DB

OMS Code 280275-00

| | | | |
|-------------------|-------------------------------|--------------|----------|
| Project Title | DART+ COASTAL NORTH | | |
| Drawing Title | Linear Works Howth Branch | | |
| Drawing File Name | D+WP56-ARP-P4-NL-DR-RO-100058 | Sheet Number | 58 of 58 |
| Status | S3 | Rev | P01 |